

Please read and save these instructions. Read carefully before attempting to assemble, install, operate or maintain the product described. Protect yourself and others by observing all safety information. Failure to comply with instructions could result in personal injury and/or property damage! Retain instructions for future reference.

# **Powerwinch®**

## **Deckmate 25 Free Fall Pontoon Windlass**

*Featuring patented  
“free fall release  
system” & over-  
sized davit roller for  
smooth hands free  
operation*

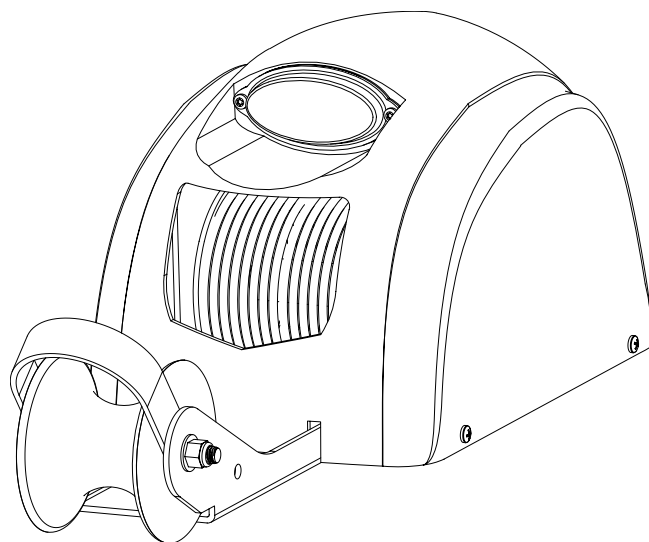

### **Description**

The Deckmate 25 Free Fall Pontoon Windlass assists in the launching and retrieving of a “mushroom” or “river” style anchor typically used on pontoon boats. This windlass has the capacity to lift up to a fifty pound anchor and the patented free fall feature gives it the ability to drop and set the anchor in a fraction of the time that it takes a traditional power down windlass. The built in light assists retrieving anchors and launching or retrieving the boat at night.

### **Unpacking**

When unpacking, inspect carefully for any damage that may have occurred during transit. Make sure any loose fittings, bolts, etc., are tightened before putting unit into service.

## **General Safety Information**

*Throughout this manual potential safety hazards will be noted with the following terms. Please read and understand these terms before operating the product.*

### **⚠ DANGER**

Danger means a hazard that will cause death or serious injury if the warning is ignored.

### **⚠ WARNING**

Warning means a hazard that could cause death or serious injury if the warning is ignored.

### **⚠ CAUTION**

Caution means a hazard that may cause minor or moderate injury if the warning is ignored. It also may mean a hazard that will only cause damage to property

**⚠ DANGER** Rope breakage and whiplash hazard.

1. Never stand between the load point and the winch. If the rope breaks it could snap back with enough force to cause severe injury or death.
2. The winch is shipped with a closed loop anchor roller. If the included anchor roller is ever replaced it must be replaced by a closed loop anchor roller. The closed loop anchor roller will prevent the anchor line from snapping onto the boat deck in the event the rope breaks.
3. Always use nylon rope specifically rated for this product. Never substitute cable for rope. Cable is not an acceptable anchor line because it does not stretch and is easily frayed. If cable breaks it can snap back with more force than nylon rope.
4. This product is intended to lift only river & mushroom anchors. Do not attempt to lift or move people or other objects with this winch.
5. Inspect entire rope for weak or worn condition or kinking (short tight twist or curl) before each use. Replace worn rope with nylon rope specifically rated for this product.

**⚠ DANGER** Electrical shock and fire hazards.

1. Do not use electrical wire sizes other than those specified in this manual. Using wire that is too small could result in overloading and a fire.
2. Use only the supplied or recommended circuit breakers when installing this winch. Using incorrect circuit breakers could result in a fire.
3. Use only marine grade, fully tinned wire for electrical connections between the battery and the winch.
4. Make sure any crimped electrical connectors meet can withstand a 25 lb pullout force before failing.
5. Always disconnect the wiring harness from the battery before attempting to install, relocate, or service the winch or switch.

**⚠ DANGER** Cruising and boat trailering hazards.

1. When the boat is cruising or being trailered, the anchor must be tied to a cleat (or other secure point) or secured with a safety chain/strap. If the anchor breaks free during cruising or trailering, it will cause serious damage and/or injury.

**⚠ WARNING** Anchoring hazards.

1. Always tie the anchor line off to a cleat (or other secure point) when the boat is anchored. The winch must not be used to hold the load of the boat while anchored. Serious damage to the motor and/or failure of the winch could occur.
2. Do not pull a load greater than the rating for the winch. If the circuit breaker halts operation of the winch during retrieval or deployment, the winch may have been overloaded. Stop using winch until the cause of the problem has been determined.

**⚠ WARNING** Entanglement hazards.

1. Never place any object or tool in the rope spool while retrieving or deploying the anchor. The tool or object could become tangled in the rope resulting in serious injury and/or damage to the winch.
2. Do not wear loose fitting clothing, scarves, or neck ties during the operation of the winch. Loose clothing may become caught in moving parts resulting in injury or death.
3. Do not operate the winch under the influence of drugs and/or alcohol.

**⚠ CAUTION** Operation hazards

1. It is always best to make sure that the windlass is visible while under operating conditions. If the rope should become “tangled” or “caught up” while retrieving or deployment of the anchor then the operator will be able to quickly turn the windlass off before damage can occur.

## Deckmate 25 Freefall Pontoon Windlass Product and Performance Specifications

Model	Maximum Anchor Weight	Line Size, Type, and Length	No Load Line Speed	Average Line Speed With 50 lb. Anchor	Motor Operating Voltage	Circuit Breaker Rating	Unit Weight	Unit Dimensions (LxWxH)
Deckmate 25	50 lbs	3/16" dia Nylon, 100' long	85 ft/min	33 ft/min	12V DC	25 amps	15 lbs.	12.25x8.5x8.25

Deckmate 25 Installation**IMPORTANT: REVIEW THESE INSTALLATION INSTRUCTIONS BEFORE INSTALLING!**

There are 5 steps to installing the Deckmate 25 that must be completed in the order below for proper installation:

1. Assembling, locating, and installing the bow roller.
2. Locating and installing the winch mechanism.
3. Deciding location for switch (on the winch or at the helm).
4. Installing the switch and wiring the winch to the battery.
5. Assembling the cover and unit test.

**STEP 1. Assembling, locating and installing the bow roller.**

The bow roller comes unassembled in the packaging with the windlass. Locate the parts shown below before starting the assembly:

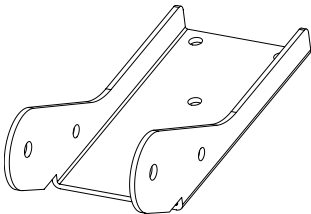

P10951 BOW ROLLER HOUSING

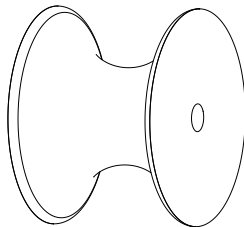

P55710 ROLLER

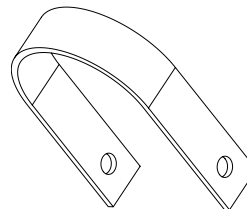

P55715 BOW ROLLER LOOP

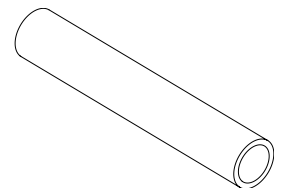

P55712 BOW ROLLER SPACER

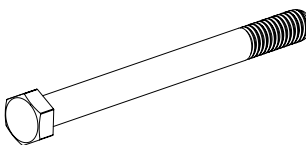

P55703 ROLLER BOLT

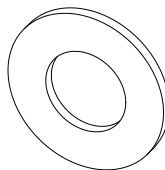

STO70932AV WASHER

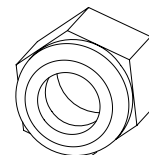

P55704 HEX NUT

## STEP 1. Assembling, locating and installing the bow roller. (Continued)

- Insert P55712 Bow Roller Spacer into P55710 as shown in Figure 1.

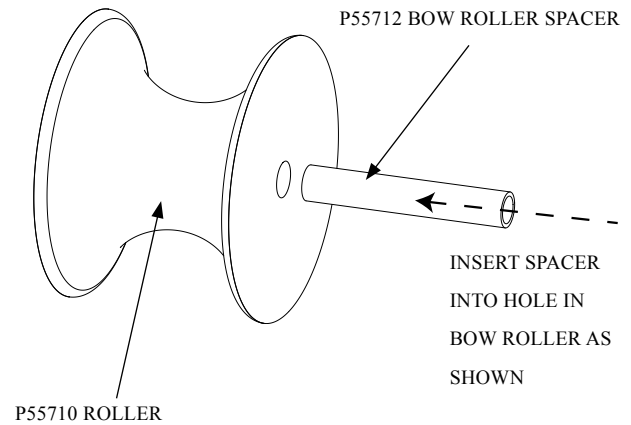

FIGURE 1. ASSEMBLING SPACER INTO ROLLER

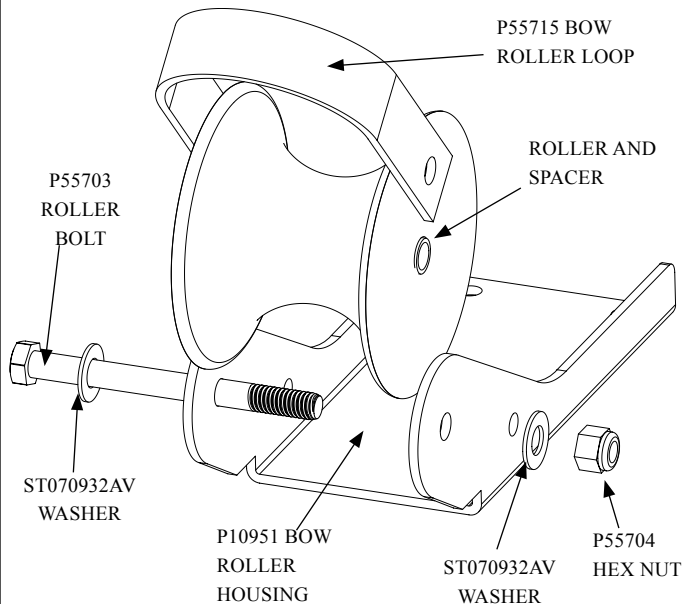

FIGURE 2. ASSEMBLING ROLLER INTO HOUSING

- Insert bow roller and spacer into P10951 Bow Roller Housing along with P55715 Bow Roller Loop as shown in Figure 2. Make sure that the loop fits inside the bow roller housing, not outside. Secure with P55703 Roller Bolt, ST070932AV Washers (one per side) and P55704 Hex Nut. The completely assembled bow roller is shown in Figure 3.

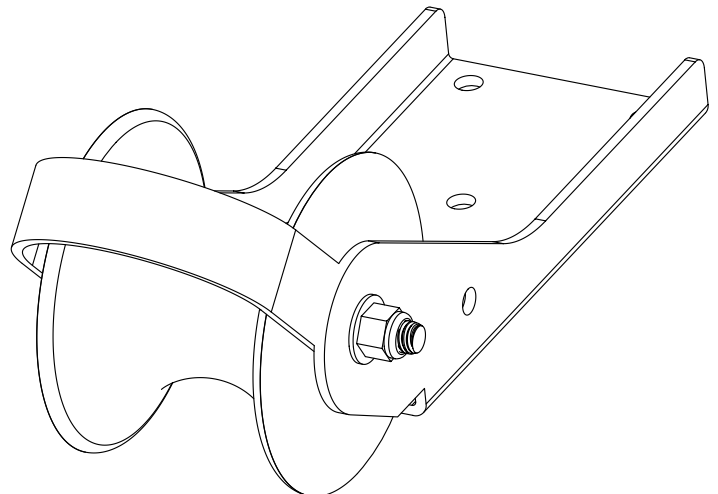

FIGURE 3. COMPLETELY ASSEMBLED BOW ROLLER

**STEP 1. Continued**

With the bow roller assembled, it can now be located on the bow of the boat.

**!!IMPORTANT!!**

**Before drilling any holes, make sure the bow roller extends over the bow or side of the boat far enough so that the anchor will not hit the boat when being retrieved or deployed.**

Locate the bow roller and mark the three holes in the bow roller on the deck of the boat. Using a 1/4" diameter drill bit, drill the holes through the deck. Using three of the 1/4-20 x 3.0 long screws in the kit (along with three lock washers, flat washers, and nuts), secure the bow roller to the deck as shown in Figure 4.

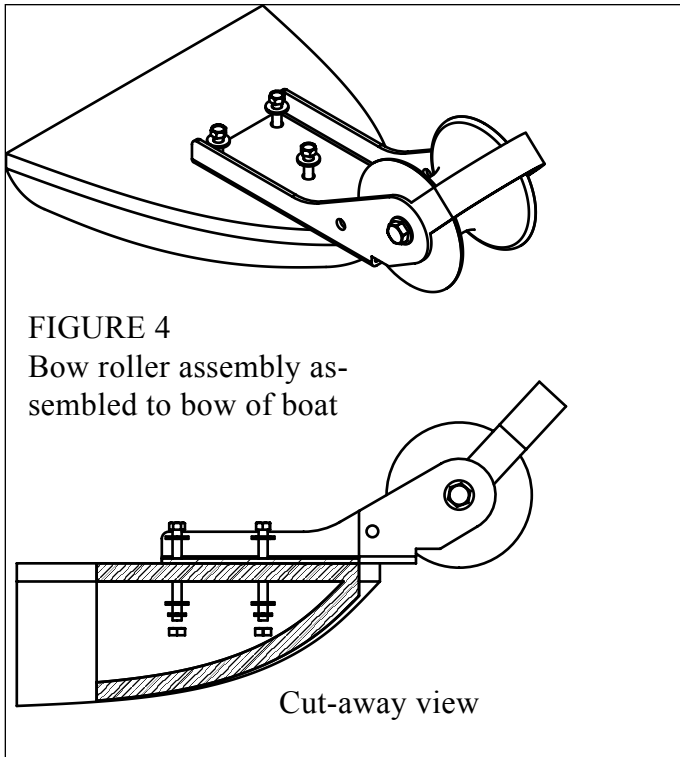
**Step 2. Locating and installing winch mechanism****!!IMPORTANT!!**

**BEFORE DRILLING HOLES TO MOUNT WINCH MECHANISM, MAKE SURE THERE IS ENOUGH SPACE BETWEEN THE BOW ROLLER AND THE WINCH COVER TO PREVENT THE ANCHOR FROM HITTING THE COVER WHEN THE ANCHOR IS RETRIEVED.**

**STEP 2. Continued**

Remove the winch mechanism from the box and locate behind the bow roller on the deck of the boat as shown in Figure 5.

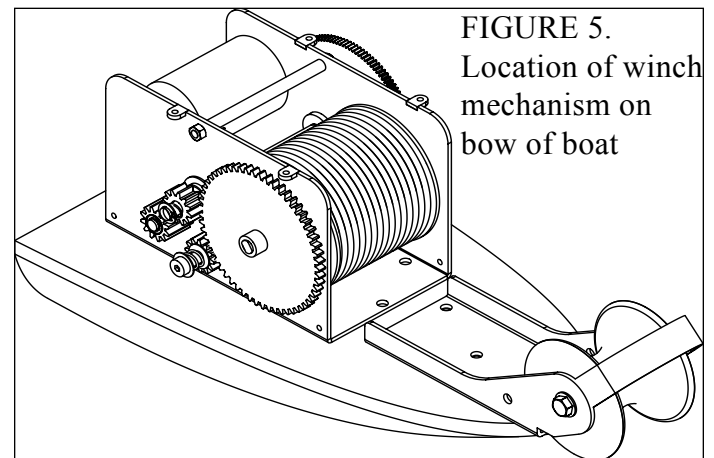

Make sure the centerline of the rope spool is in line with the center line of the bow roller as shown in Figure 6. If the winch is not properly aligned with the bow roller, the winch will not operate properly.

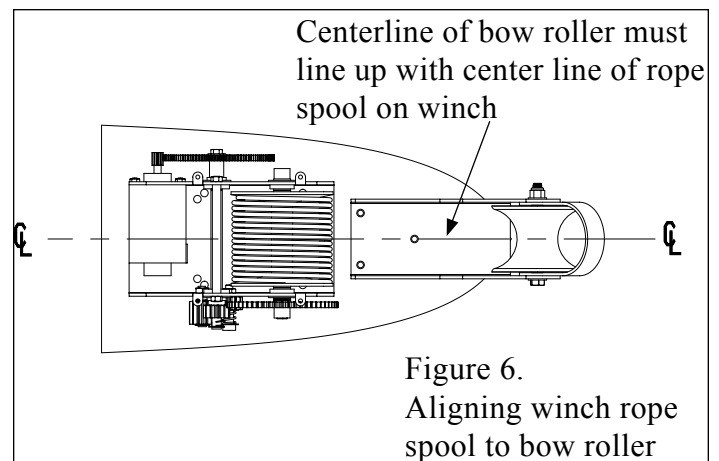

Remove cover from box and place over winch as shown in Figure 7.

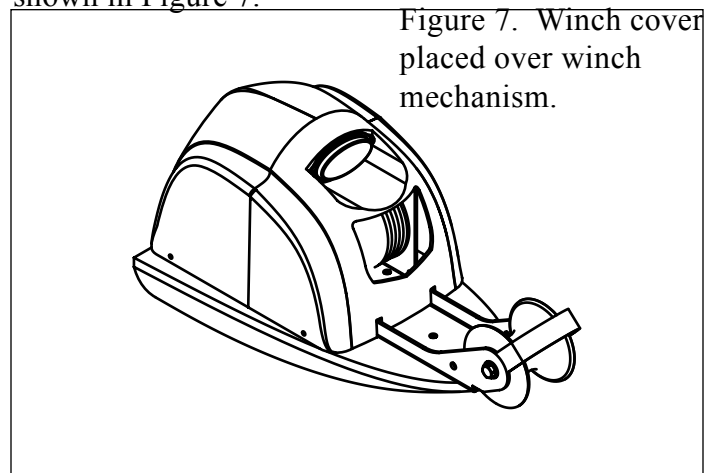

**STEP 2. Continued**

Place the anchor in the bow roller and make sure the shank of the anchor does not touch the winch cover when the anchor is seated in the bow roller. See Figure 8.

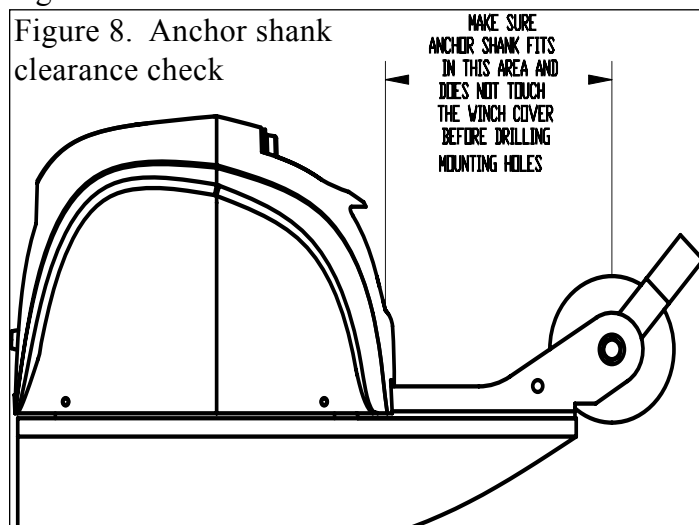

Once it is certain the anchor will not hit the cover of the winch, remove the cover. Using a permanent marker, mark the deck through the mounting holes in the winch frame. Figure 9 shows which holes in the winch frame should be used as mounting holes.

Figure 9. Locating mounting holes.

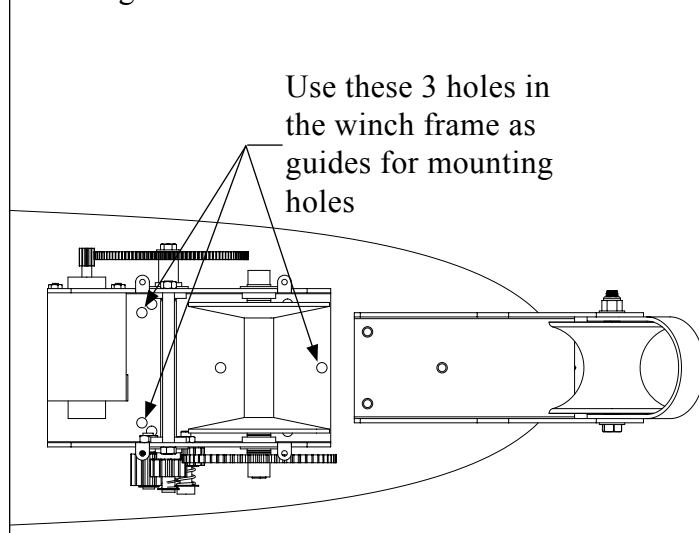

After marking the holes as shown, remove the winch and drill the holes through the deck using a 1/4" drill bit.

**STEP 2. Continued****Wiring Harness Hole:**

A hole in the deck is needed to pass the wiring harness from the battery through to the winch. Locate the template at the end of this manual and place it on the deck. Line up the mounting holes on the template with the mounting holes that were just drilled on the deck. Find the hole on the template for the wiring harness and mark it on the deck. Remove the template and drill the hole with a 5/8" drill bit.

With all the mounting holes drilled, secure the winch to the boat deck using the fasteners included in the kit. Refer to Figure 10 for proper assembly of the fasteners.

Figure 10. Location of mounting fasteners

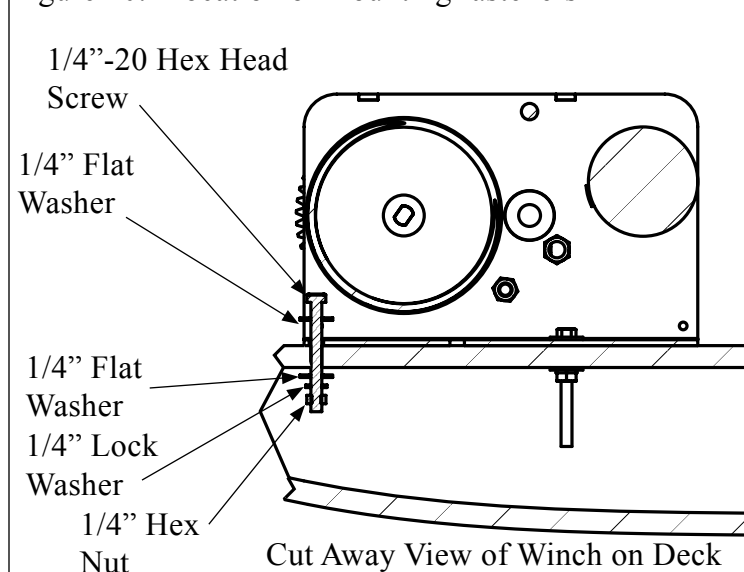
**Step 3. Deciding Location of Switch**

The Deckmate 25 has the capability of having the switch mounted on the winch cover or at the helm of the boat. Some items to consider about the location of the switch:

1. Locating the switch on the helm will allow the boat to be steered toward the anchor point when the winch is being used.
2. Locating the switch on the helm will require extra wiring for the light to be operational.
3. Locating the switch on the helm will require a switch cover plate to be installed on the winch cover. This cover plate is included with the winch kit.

**Step 4. Installing the switch and wiring the winch to the battery.**

To install the switch on the helm, go to Page 7. To install the switch on the winch cover, go to Page 9.

**Step 4.** Installing the switch and wiring the winch to the battery. (continued).

### Installing The Switch On The Helm

1. Find a suitable location to install switch. Make sure there is enough room behind the switch mounting location for the switch and wiring to the switch.
2. Cut a rectangular hole that is 1 7/8" wide by 1 5/8" high. Refer to Figure 11.

Figure 11. Size Of Switch Mounting Hole

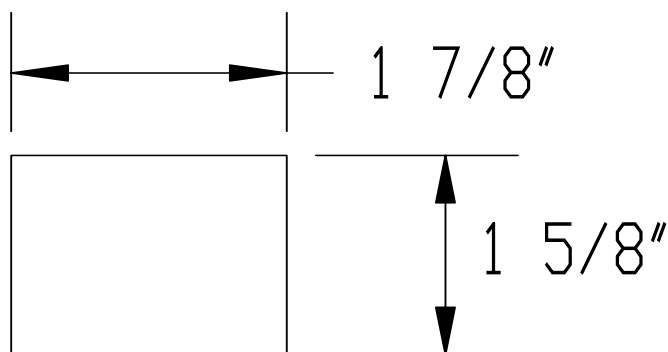

3. Locate rocker switch in parts pack and assemble into switch plate as shown in Figure 12.

Figure 12. Switch Plate Assembly

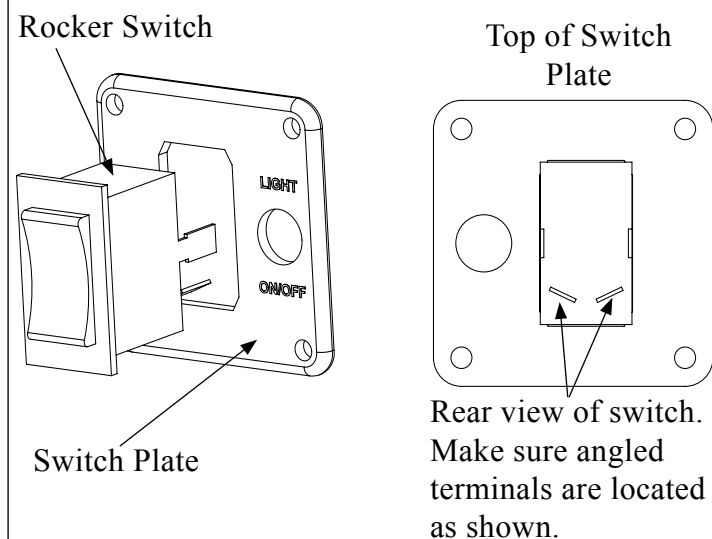

4. Locate push button switch for light and rubber boot that fits over switch and assemble as shown in Figure 13.

**Step 4.** Installing the switch and wiring the winch to the battery. (continued).

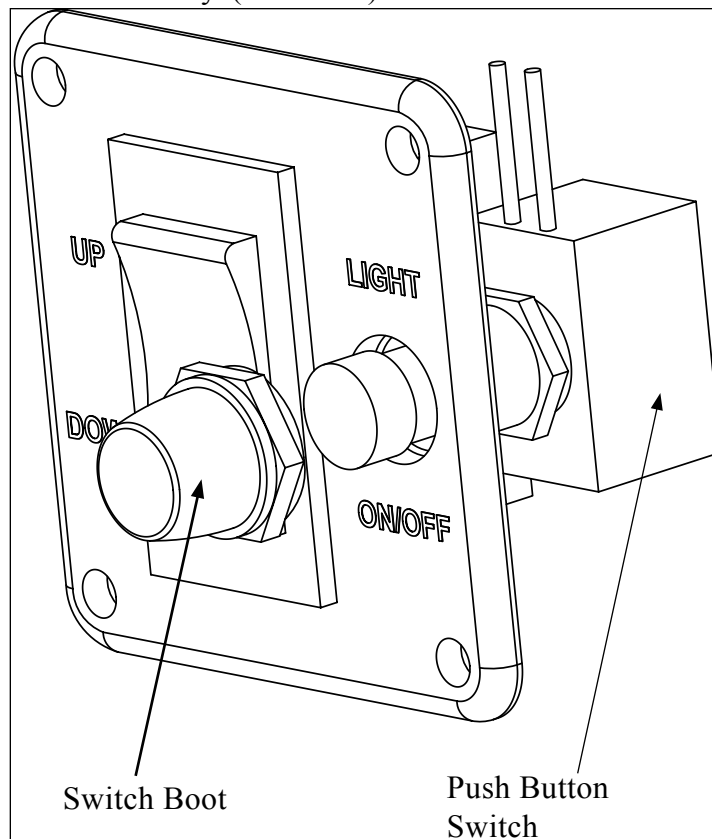
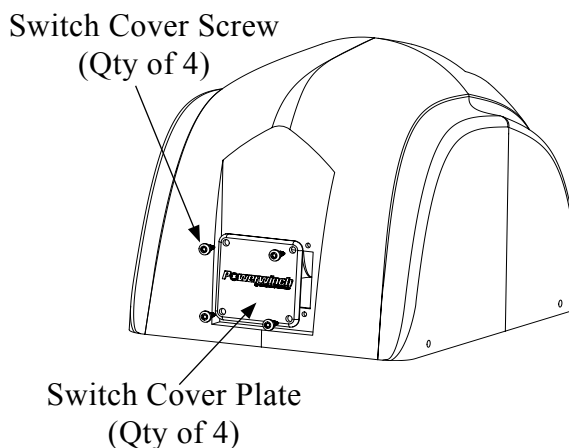

Figure 13. Light Switch Assembly.

Insert push button switch through hole in switch plate and secure with switch boot.

5. Locate the switch cover plate in the parts pack and the four screws needed to secure the plate to the winch cover. Assemble the switch cover plate as shown in Figure 14.

Figure 14. Switch Cover Plate Assembly



6. Refer to Figure 15 for the wiring needed between the winch, switch and battery. The kit contains all the parts needed to complete the wiring.

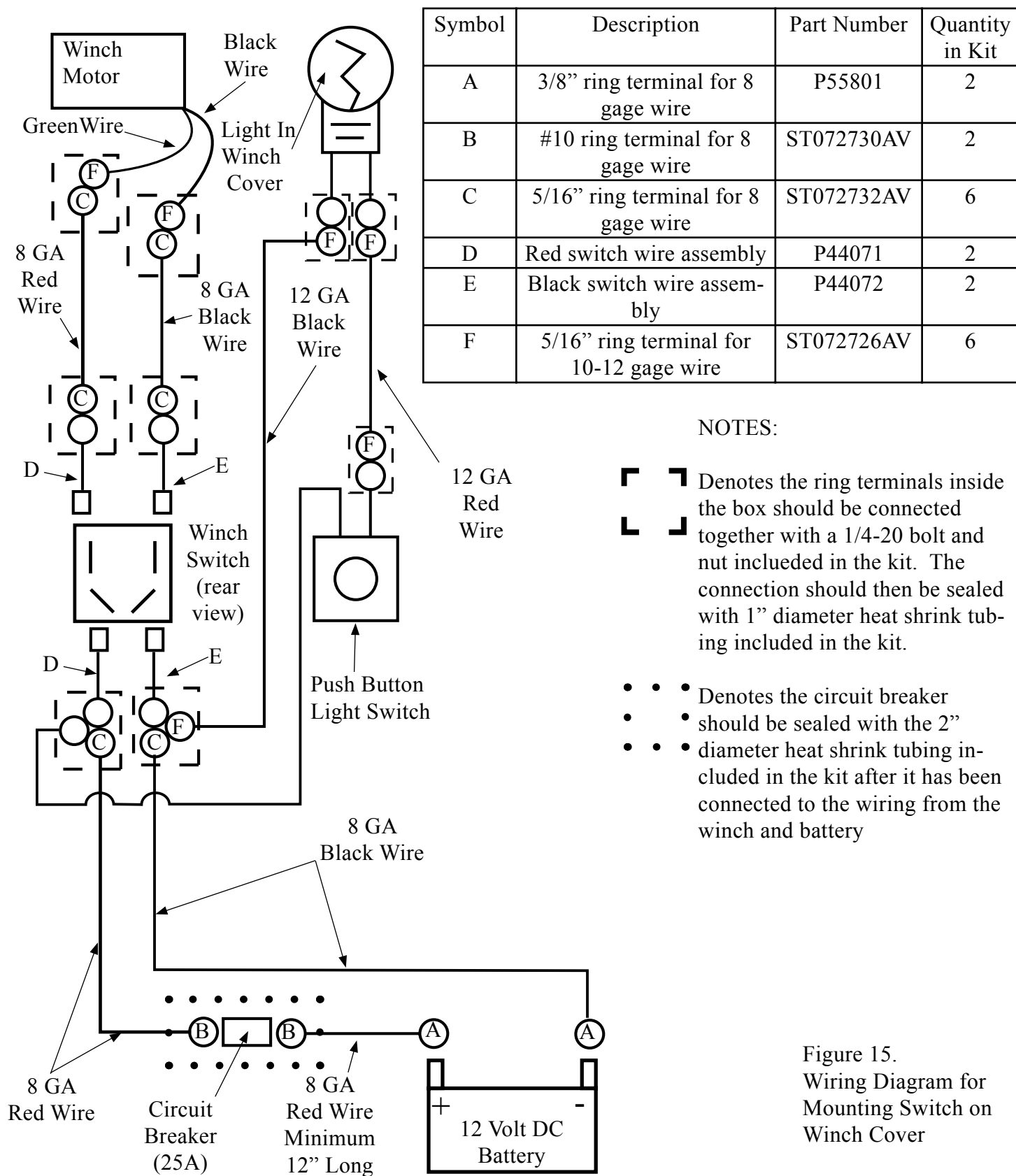

**Step 4.** Installing the switch and wiring the winch to the battery. (continued).

7. After the wiring has been installed as shown in Figure 15, place the switch plate assembly into the hole cut in the panel and mark the holes for the switch plate as shown in Figure 16. Drill pilot holes with a 1/8" drill bit

Figure 16. Switch Plate Assembly

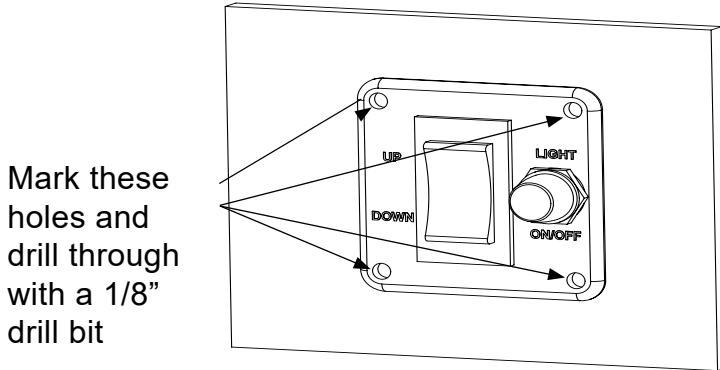

8. Secure switch plate to helm using screws supplied in kit at shown in Figure 17.

Secure switch plate using screws in kit

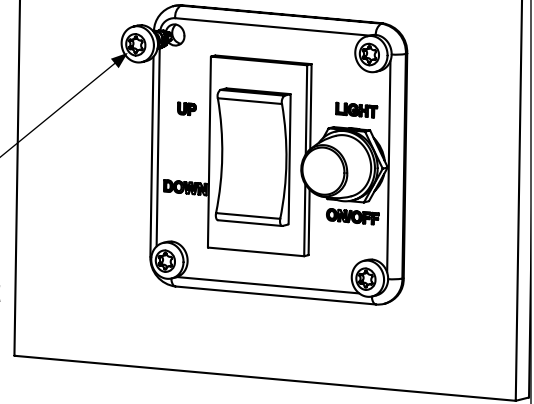
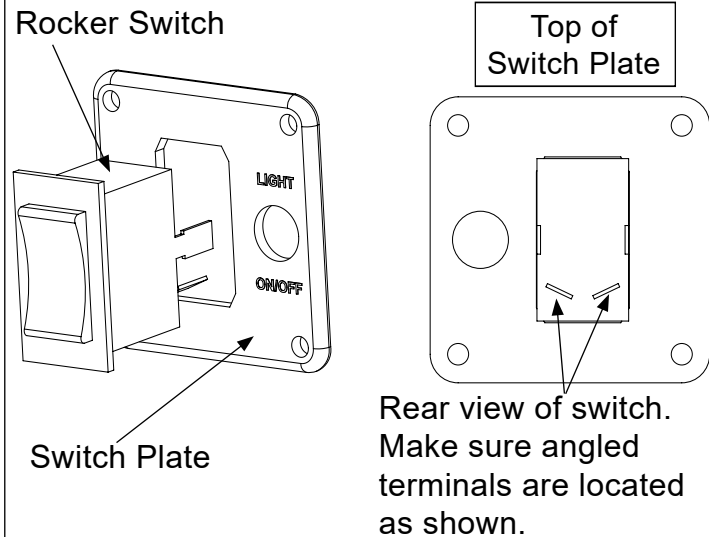

Figure 17. Securing switch plate to helm

### Installing The Switch On The Winch Cover

1. Locate rocker switch in parts pack and assemble into switch plate as shown in Figure 16.

Figure 16. Switch Plate Assembly



2. Locate push button switch for light and rubber boot that fits over switch and assemble as shown in Figure 17.

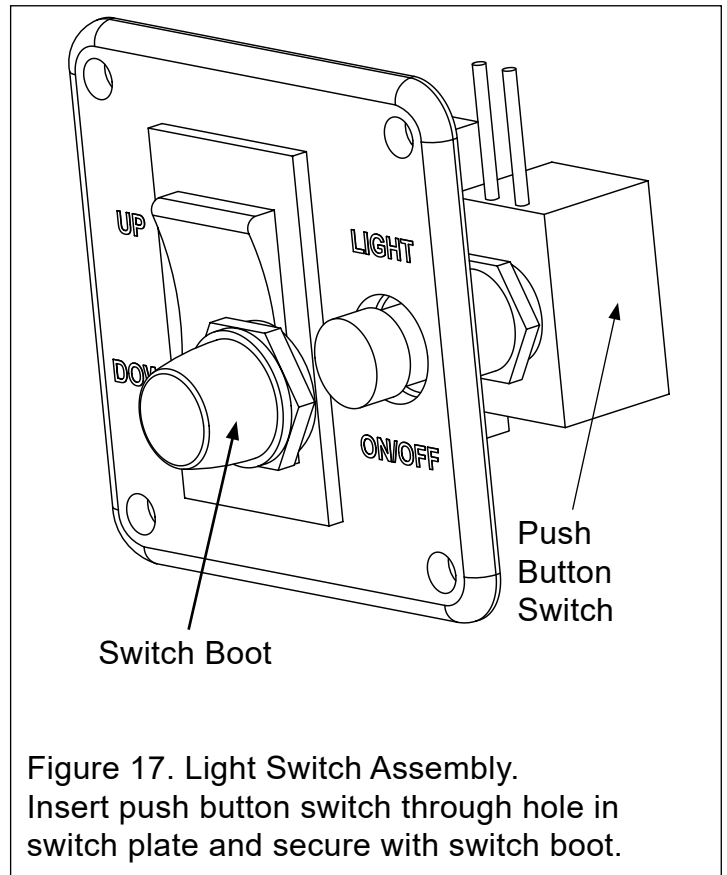
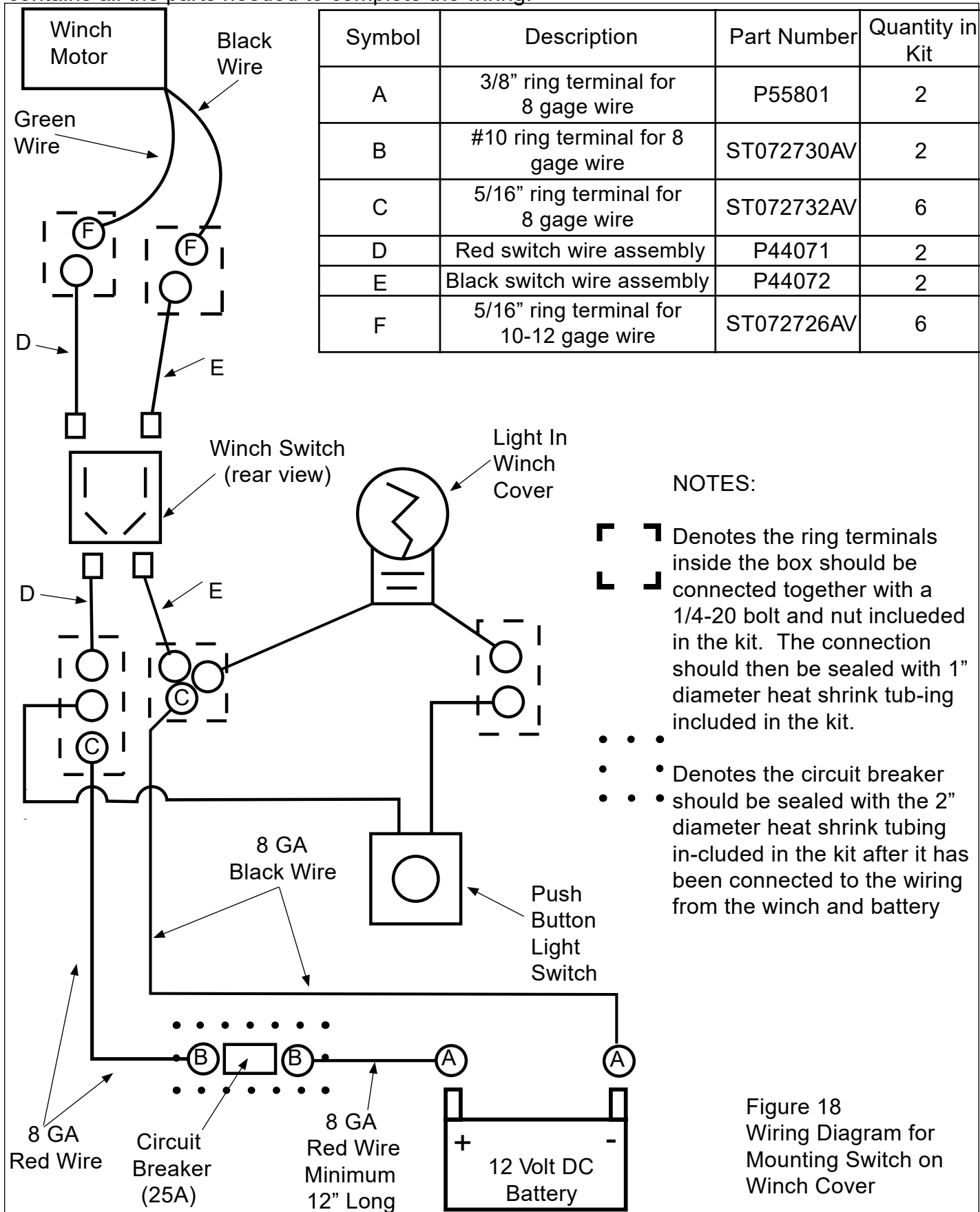

Figure 17. Light Switch Assembly. Insert push button switch through hole in switch plate and secure with switch boot.

3. Refer to Figure 18 for the wiring needed between the winch, switch and battery. The kit contains all the parts needed to complete the wiring.



**Step 5. Assembling Winch Cover and Unit Test**

1. Before securing cover to winch frame, make sure all wiring from the switches, light, and battery are clear of the winch gears. Wire ties may be used to secure these wires to the winch frame.
2. Locate the cover mounting bars (4 total, 2 per side) and cover mounting screws in the winch parts pack.
3. The winch cover screws pass through the cover and the cover mounting bars to thread into the winch frame as shown in Figure 19.

Figure 19. Assembling Winch Cover

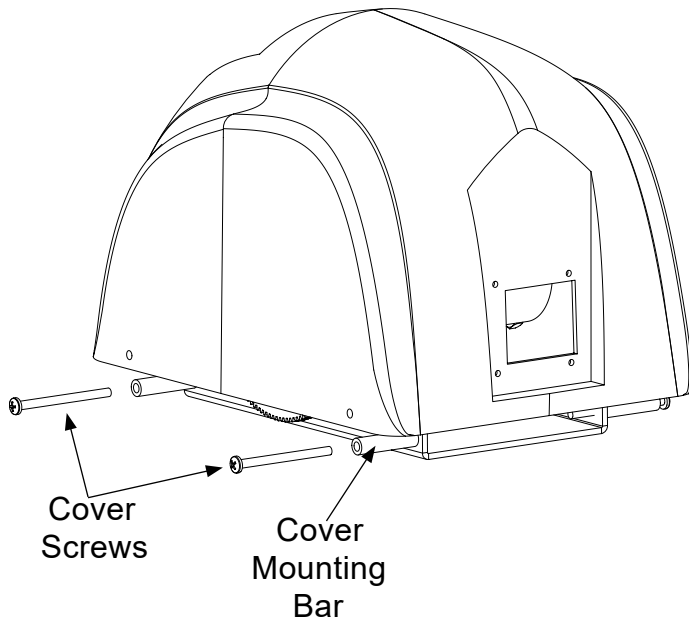

4. If you are mounting the switch to the winch cover, locate the four screws that are needed to secure the switch plate in Figure 17 and assemble them as shown in Figure 20.

Secure  
switch plate  
using  
screws in kit

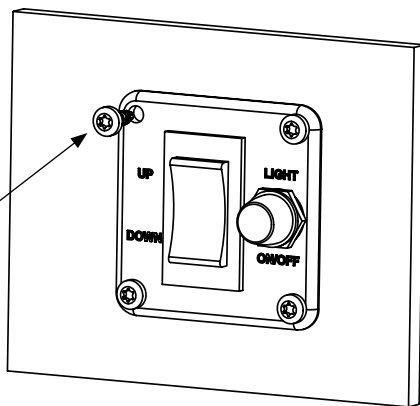

Figure 20. Securing switch plate to winch cover

**Step 5. Assembling Winch Cover and Unit Test**

## Unit Test

1. Make sure area around winch is clear of all people and objects.
2. Press the rocker switch in the down position and hold for 5 seconds. The motor will reverse the gear train and the winch is now in free-fall mode.
3. Release switch and pull approximately three feet of rope out of the winch.
4. Now press rocker switch in the up position and hold. The winch will now reverse direction and pull rope back into winch.
5. Press light push button switch in once and the light should illuminate. Press switch in again and the light should go out.

## Recommended Operating Procedures

### Attaching the Anchor

**Note:** Powerwinch recommends using a shackle to attach the anchor to the anchor line.

1. Locate the loop at the end of the anchor line on the spool.
2. Pass the shackle through this loop and then secure the anchor by passing the shackle pin through the anchor shank line. Securely tighten the shackle pin. See Figure 21 for reference.

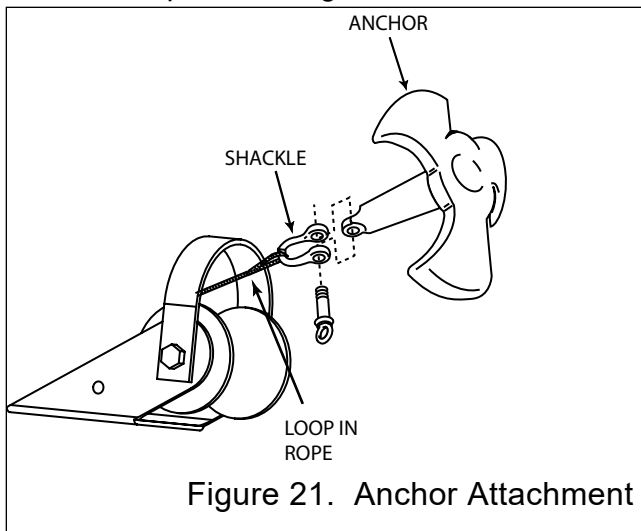

### Deploying The Anchor

1. Once an anchoring spot has been located and the depth of the water is estimated, the anchor can be dropped.
2. Turn the the boat into the wind and put the mo-tor in neutral.
3. Once the boat has stopped all forward progress, press the switch in the down position and hold for 5 seconds.
4. The anchor will release from the bow roller and free-fall into the water. Once the anchor has stopped free-falling, reverse the motors on the boat and pull out as much rope as needed to safely anchor.

**CAUTION** Always wait for the anchor to stop falling before retrieving the anchor line. Retrieving the anchor line while in free-fall will damage the winch and void your warranty.

5. Once the desired amount of rope has been let out, Press the switch in the up position and retrieve approximately 3 feet of line. This will lock the winch and prevent any more line from paying out.

**CAUTION** Always tie the line off to a cleat when anchored. Do not use the winch to solely hold the load of the anchor line.

### Retrieving the Anchor

1. Untie the anchor line from the cleat.
2. Align the boat with the anchor line.
3. Engage boat motor and slowly begin to move forward the anchor.
4. Press the winch switch in the up position and hold to pull the anchor line in.

**CAUTION** Never use the winch to solely move the boat toward the anchor. Always slowly move forward the anchor using the boat motor.

5. Once the anchor is out of the water, jog the switch to get the anchor up into the bow roller.

**CAUTION** Never slam the anchor into the bow roller. This will cause damage to the winch and may prevent the anchor from free-falling on the next anchor deployment.

6. Once the anchor has been pulled into the bow roller, always tie the anchor off to a cleat.

**WARNING** Always tie off the anchor to a cleat after retrieval. This will prevent the anchor from breaking free in transit.

**CAUTION** Never use the wind-lass to break a stuck anchor free. This may overload the windlass and cause damage to the gear train.

## Maintenance

Periodic maintenance to the Free Fall Pontoon Windlass will help to extend the service life of the equipment and the following steps can be taken to do this.

**Always disconnect power to the windlass at the battery before performing any maintenance on the unit.**

1. Lubricate the gear train with a lithium grease at the beginning of each boating season.
2. Lubricate the shaft on the davit roller with a small amount of lithium grease at the beginning of each boating season.
3. Inspect the anchor line at the beginning of each boating season. Replace the 3/16" diameter, 3 strand nylon rope if it is frayed, cut or kinked. When replacing the rope refer to the following instructions.

### Anchor Line Replacement

Make sure that the windlass is in the free fall mode of operation. Next, disconnect the power to the windlass at the battery. Locate the portion of the rope that inserts through the hole of the rope spool. Push on this end so that the knotted portion of rope on the opposite side of the flange is pushed out of the counter bore and is exposed. Take a thin screwdriver or flexible piece of wire and pull the knotted rope end out from between the frame and rope spool flange. Untie the knot or cut the rope just below the knot and pull the rope out of the spool.

Take the new rope and hold onto the non looped end and throw the rope out into the water. Follow the illustration in Figure 22 to install the rope onto the spool.

Note: The illustrations in Figure # depict the rope spool unattached to the windlass for clarity purposes. The rope spool can be left assembled to the windlass when replacing the rope.

Reconnect the power to the windlass at the battery. Finally, wind the rope onto the rope spool while being careful to maintain even wraps of rope as it winds.

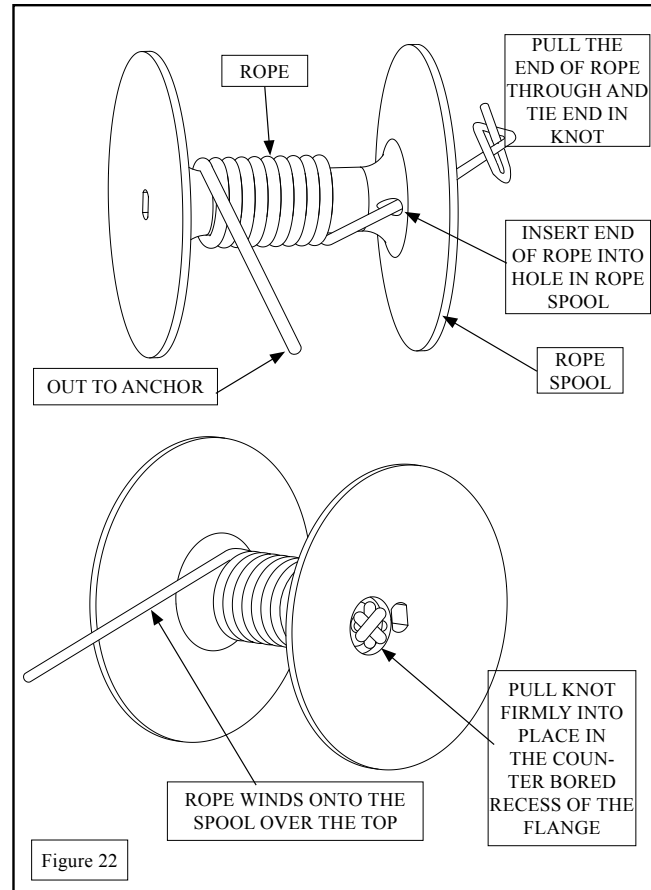

### Light Bulb Replacement

**⚠ WARNING** To prevent damage to light, do not operate light for longer than 15 minutes.

1. Remove the two screws that hold the lens against the winch cover.
2. Remove gasket and inspect for tears or damage, replace if necessary.
3. Rotate the expired light bulb a 1/4 turn or 90 degrees inside the clips and pull out.
4. Replace with new light bulb and reinstall gasket, lens and hardware. The light bulb is a 212-2 automotive bulb.

## Troubleshooting Guide

<u>Symptom</u>	<u>Possible Causes</u>	<u>Corrective Action</u>
Windlass does not operate.	1. Disconnected wires, bad circuit breaker, bad switch.	1. Start by checking the wiring at the battery. Bypass the circuit breaker and test the winch. If the winch operates, replace the circuit breaker. 2. Check wiring insulation for worn or bare spots that may be causing a short. 3. Check all connections for tightness.
The windlass runs but will not retrieve rope.	1. Wave springs on locking gear are worn.	1. Replace wave springs and push nut.
Anchor tends to free fall too quickly and the rope gets tangled up on the rope spool.	1. The drag gear spring and washers are worn.	1. Replace the washers and drag gear spring.

### Limited Warranty

- A. This Limited Warranty is given by the Powerwinch Division of the Scott Fetzer Company (the "Company") to the original purchaser (the "Purchaser") of a Powerwinch Product (the "Product") specified in this manual. This Limited Warranty is not transferable to any other party.
- B. Responsibilities of the Company under this Limited Warranty:
1. Repair or replace (at the discretion of the Company) any part or parts of the Product found by the Company to be defective within a two (2) year period from the date of purchase.
  2. The Company will pay the transportation charge for shipment back to the Purchaser of any Product received for legitimate Warranty repair.
- C. Responsibilities of the Purchaser under this Limited Warranty:
1. Purchaser will have to show dated proof of purchase to qualify for service under the provisions of the Limited Warranty.
  2. Promptly notify the Seller or the Company of any claim hereunder.
  3. At the Option of the Company, return the Product to the Company for inspection. Authorization must be given prior to any Product return. Call the Company at 1-800-243-3097 or write the Company at 2268 Fairview Blvd Fairview, TN 37062 for authorization and complete instructions on how to return the Product directly to the Company.
  4. Use reasonable care in maintenance, operation, use and storage of the Product in accordance with the instructions contained in the Owner's Manual.
  5. Have Warranty work performed by a dealer or representative approved by the Company.
  6. Except as noted in B.2., transportation charges are the responsibility of the Purchaser.
- D. This Limited Warranty covers:
1. Defects in workmanship or materials.
  2. Any part or parts of the Product sold or manufactured by the Company.
- E. This Limited Warranty does not cover:
1. Any failure that results from improper installation of the Product.
  2. Any failure that results from accident, Purchaser's abuse, neglect, modification, improper maintenance, or failure to operate and use the Product in accordance with the instructions provided in the Owner's Manual supplied with the Product.
- F. There is no other express warranty. Implied warranties, including those of merchantability and fitness for a particular purpose, are limited to one (1) year from date of purchase. This is the exclusive remedy and any liability for any and all incidental or consequential damages or expenses whatsoever is excluded.

Some states do not allow limitations on how long an implied warranty lasts, or do not allow exclusion or limitation of incidental or consequential damages, the above limitations may not apply to you. This Limited Warranty gives you specific legal rights, and you may also have other rights which vary from state to state.

**Technical Information**

For information on the operation or repair, please call 1-800-793-4793.

**Replacement Parts Information**

For information regarding where to order replacement parts, call 1-800-793-4793.

Please have the following information available:

- Winch Model Number
- Winch Serial Number
- Part Number and Description

**Address correspondence to:**

SFEG/Powerwinch  
Attn: Customer Service  
2268 Fairview Blvd  
Fairview, TN 37062

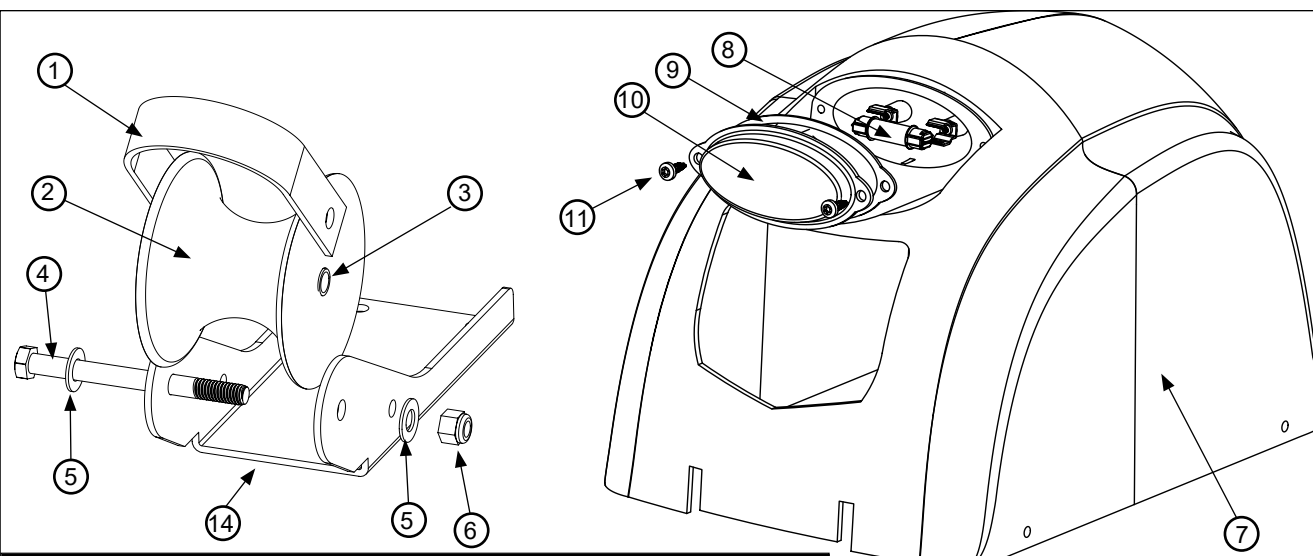

ITEM #	PART #	DESCRIPTION	QTY
1	P55715	BOW ROLLER LOOP	1
2	P55710	ROLLER	1
3	P55712	SLEEVE	1
4	P55703	BOLT	1
5	ST070932AV	WASHER	2
6	P55704	NUT	1
7	P44030	COVER	1
8	P55908	LIGHT BULB	1
9	P55932	GASKET	1
10	P55909	LENS	1
11	P55919	LIGHT SCREW	2
12	P44040	COVER SCREW	4
13	P44031	COVER SUPPORT BAR	4
14	P10951	BOW ROLLER HOUSING	1

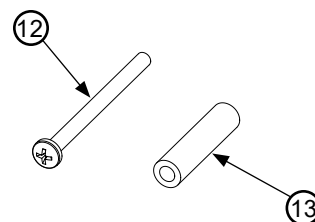

P44200 DECKMATE  
25 PARTS LIST:  
WINCH COVER BOW  
ROLLER

P44200 DECKMATE  
25 PARTS LIST:  
WINCH MECHANISM  
SWITCH

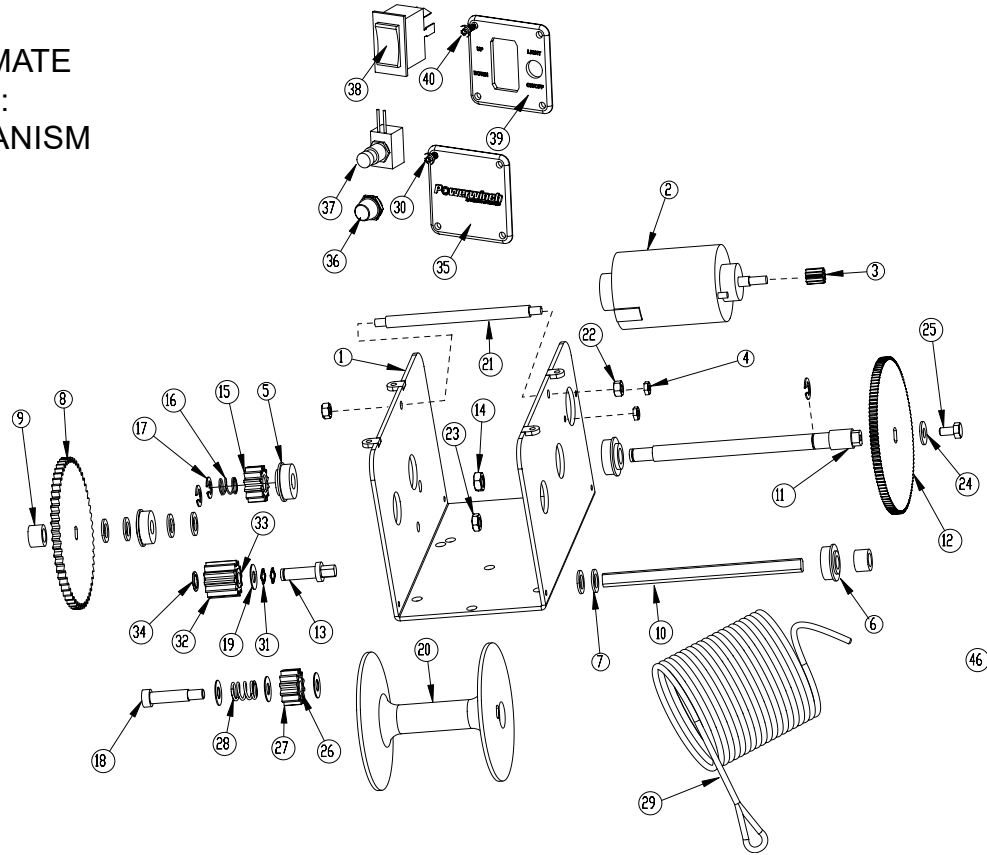

ITEM #	PART #	DESCRIPTION	QTY
1	P44001	FRAME	1
2	P44073	MOTOR, 12-VOLT	1
3	P71721	GEAR, 10-T	1
4	P79701	HEX NUT, #10-32	2
5	P71607	BEARING, INT SHAFT	2
6	P71623	BEARING, ROPE SHAFT	2
7	P79811	SPACER	6
8	P44003	GEAR, 57-T	1
9	P79731	HEX NUT, NYLOCK	2
10	P44002	SHAFT, ROPE SPOOL	1
11	P44004	SHAFT, INT	1
12	P44007	GEAR, 120-T	1
13	P44008	SHAFT, LOCKING GEAR	1
14	P44009	HEX NUT, 3/8-16	1
15	P44012	GEAR, SPIN-OFF	1
16	P10209	SPRING, CONICAL	1
17	P30038	E-RING	2
18	P10213	SHSS, 3/8 X 1.25	1
19	P71612	WASHER, THRUST .030	4
20	P73714	SPOOL, ROPE	1
21	P44017	SUPPORT BAR, FRAME	1
22	P79728	HEX NUT, 1/4-20	2
23	P10278	HEX NUT, 5/16-18	1
24	P10273	WASHER, 1/4 ID	1

ITEM #	PART #	DESCRIPTION	QTY
25	P79520	HHCS, 1/4-20 X .50	1
26	P71603	BEARING, NEEDLE	1
27	P71780	GEAR, DRAG	1
28	P71909	SPRING, COMPRESSION	1
29	P22107	NYLON ROPE, 3/16 X 100'	1
30	P55919	SCREW, SELF TAP, #8-16	4
31	P44035	WAVE SPRING	2
32	P71778	GEAR, LOCKING	1
33	P71638	BEARING, CLUTCH	2
34	P44034	PUSH NUT	1
35	P44041	SWITCH COVER PLATE	1
36	P55929	SWITCH BOOT	1
37	P55930	PUSH BUTTON SWITCH	1
38	P44039	ROCKER SWITCH	1
39	P44037	SWITCH PLATE	1
40	P10335	SWITCH PLATE MOUNTING SCREW	4
NOT SHOWN	P44050	WIRING AND MOUNTING KIT	1

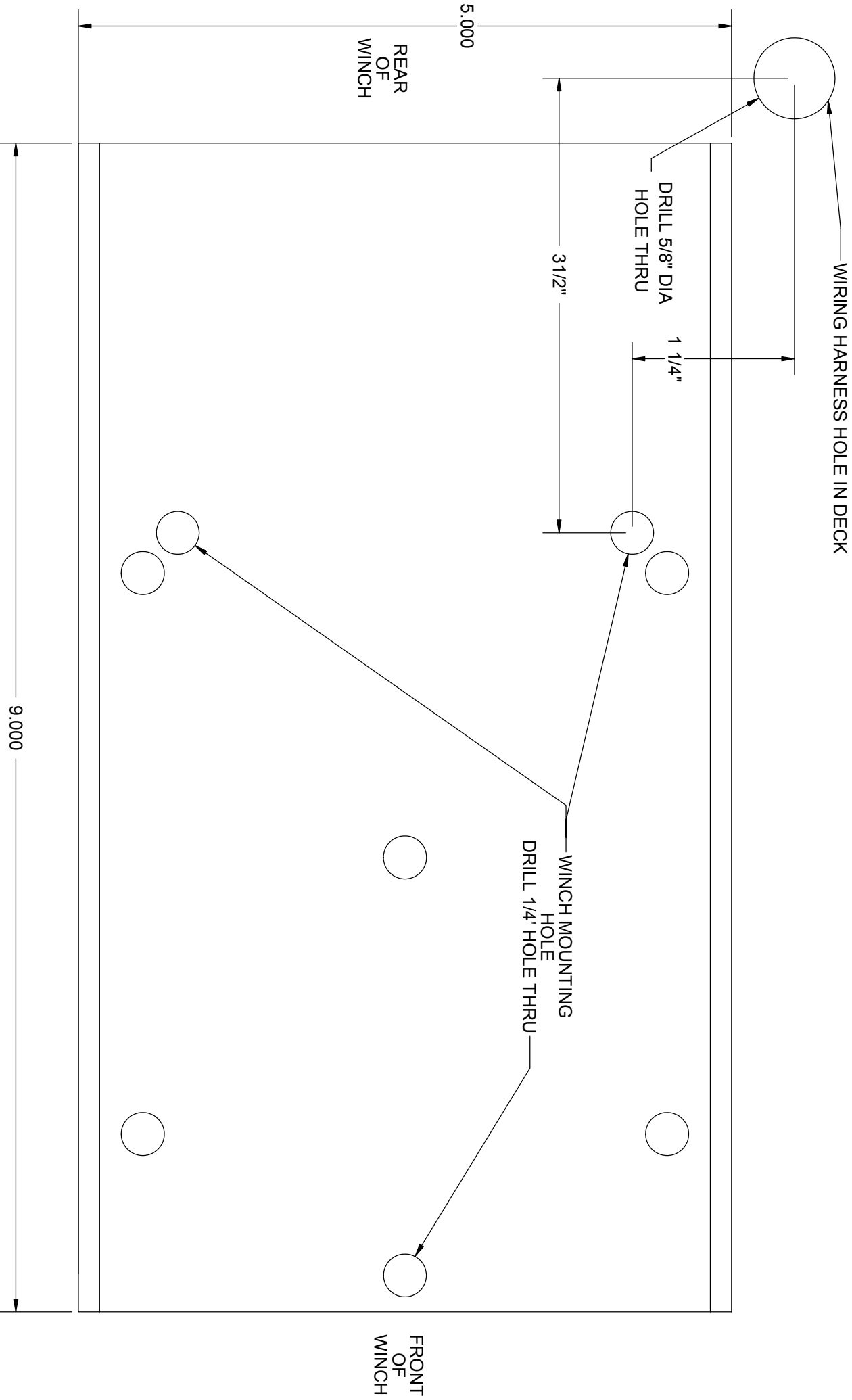

POWERWINCH DECKMATE 25 MOUNTING TEMPLATE

PLACE TEMPLATE ON DECK AND MARK MOUNTING HOLES.

DRILL HOLES THROUGH WITH DRILL SIZE NOTED ON TEMPLATE

FOR TECHNICAL ASSISTANCE PLEASE CALL 1-800-793-4793

POWERWINCH  
2268 FAIRVIEW BLVD  
FAIRVIEW, TN 37062