

Please read and save these instructions. Read carefully before attempting to assemble, install, operate or maintain the product described. Protect yourself and others by observing all safety information. Failure to comply with instructions could result in personal injury and/or property damage! Retain instructions for future reference.



### **Description**

The Windlass Footswitch Kit is designed to function with a motor reversing solenoid in order to operate a 12-volt rope/chain windlass from a remote location on the boat deck.

### **Unpacking**

When unpacking, inspect carefully for any damage that may have occurred during transit. Make sure any loose fittings, bolts, etc., are tightened before putting unit into service.

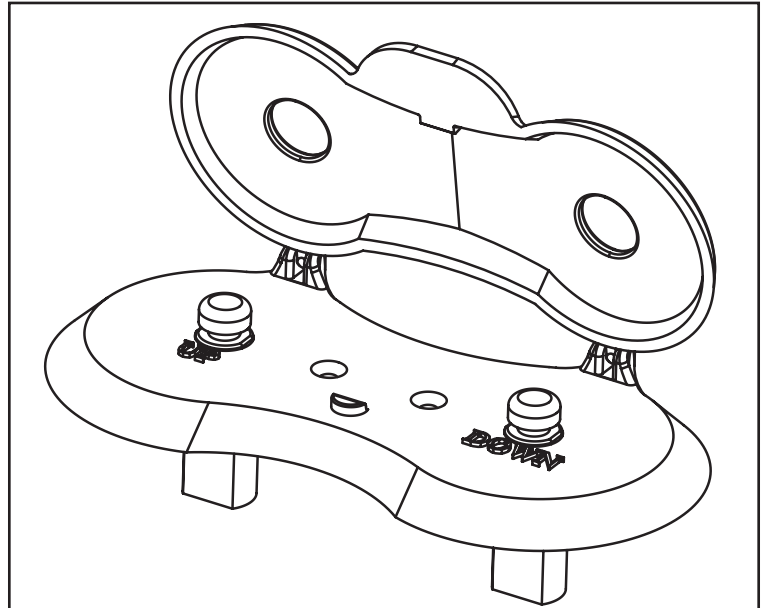

## **General Safety Information**

Throughout this manual potential safety hazards will be noted with the following terms. Please read and understand these terms before operating the product.

### **⚠ DANGER**

Danger means a hazard that will cause death or serious injury if the warning is ignored.

### **⚠ WARNING**

Warning means a hazard that could cause death or serious injury if the warning is ignored.

### **⚠ CAUTION**

Caution means a hazard that may cause minor or moderate injury if the warning is ignored. It also may mean a hazard that will only cause damage to property

### **⚠ DANGER**

The switches contained in this kit are not rated to handle the amperage need to operate a windlass and must be used in conjunction with a motor reversing solenoid.

### **⚠ DANGER**

Be sure to follow the wire size and circuit breaker recommendations called for by the windlass manufacturer.

### **⚠ CAUTION**

Always disconnect wiring harness from battery before attempting to install, service, or relocate unit.

### **⚠ DANGER**

Always keep wires away from intense sources of heat. Be sure that newly installed wires are away from any exposed bare wires.

### **⚠ DANGER**

Always close footswitch cover when not in use.

**Installation Instructions**

**MOUNTING**

1. Locate an area on the boat deck to mount the Footswitch. Ideally, the location will be a place where there is a clear line of sight to the windlass and no obstacles in the way.
2. Place the footswitch housing in the chosen location and mark the four hole centers with a center punch or permanent marker using the footswitch housing as a guide. Remove the footswitch housing.
3. Drill the two holes for the switches with a 1 inch hole saw or spade bit. Drill the two holes for the mounting screws with a 3/16 inch drill bit.
4. Make sure that the plastic switch nuts are tightened down securely on both of the switches. Feed the wires for one switch down through one of the 1 inch holes and then repeat this procedure with the other switch (See Figure #1).
5. With both switches in place in both holes place the Footswitch Housing and cover (parts P55501 and P55502) over the switches as shown in Figure #1. If preferred, a bead of silicone can be placed along the bottom edge of the housing to provide a good seal against the boat deck.

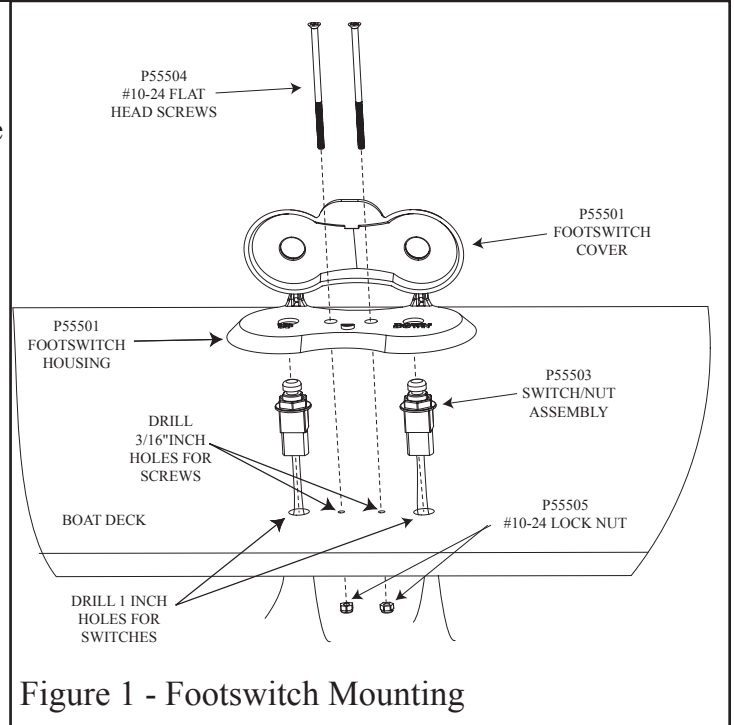

Figure 1 - Footswitch Mounting

6. Finally, secure the Footswitch housing to the boat deck by inserting the two #10-24 screws through the housing and deck and tightening the nuts from underneath. Be careful not to over tighten the nuts.

**Wiring Instructions**

**GENERAL WIRING SCHEMATIC**

1. The P55500 Footswitch Kit can only be used with a motor reversing solenoid. The Footswitch is not rated to handle the amp load of a typical windlass.
2. The motor reversing solenoid should already be mounted in a secure, dry area on the boat.
3. Figure #2 is a detailed wiring schematic of the P55500 Footswitch wired to a Powerwinch solenoid (#P10282), most motor reversing solenoids are very similar in appearance to the one shown in this diagram. Be sure to follow the solenoid manufacturers wiring schematic when wiring the footswitch to the solenoid.
4. If the Powerwinch motor reversing solenoid is being used to operate the windlass then it is recommended to use #16 gage wire to run from the switches to the control coil of the solenoid.
5. When wiring the switches to the control coil of the motor reversing solenoid one wire from each switch should be connected to the positive of a 12-volt circuit as shown in Figure #2.

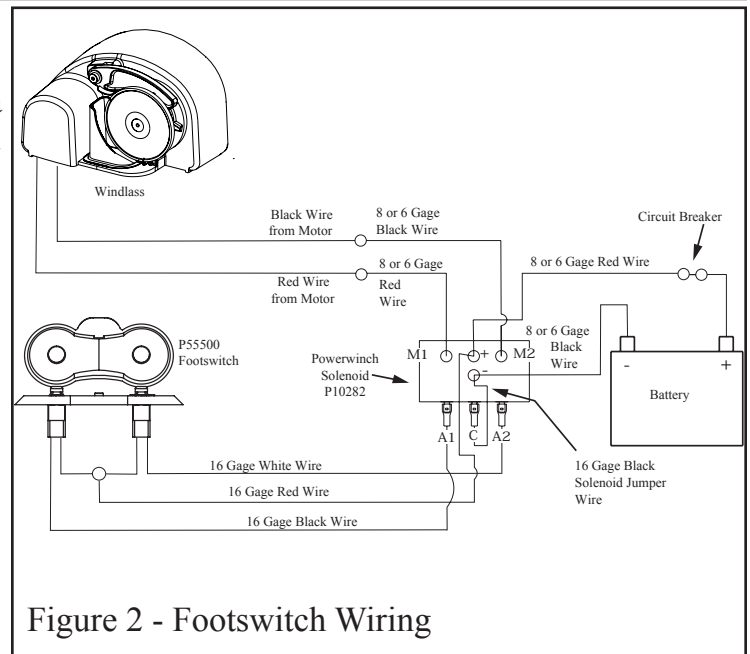
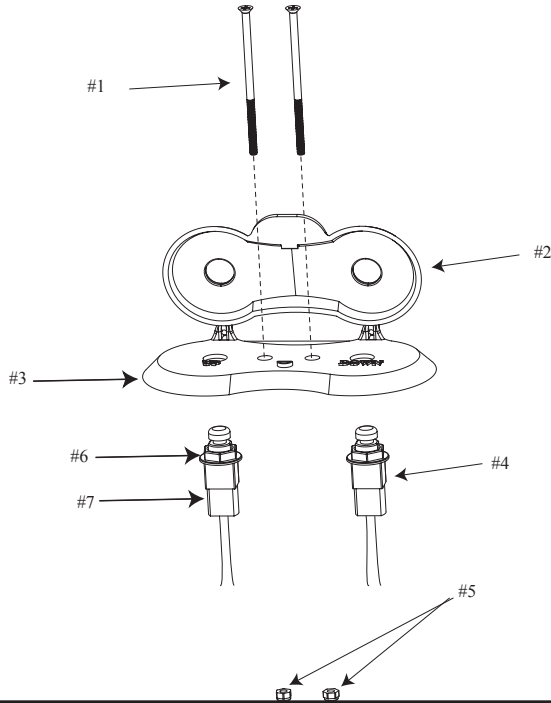

Figure 2 - Footswitch Wiring

6. The other wire from each switch is connected to the open spades at the motor reversing solenoid as shown in Figure #2.



P55500 Footswitch Kit Replacement Parts



ITEM #	PART #	DESCRIPTION	QTY
1	P55504	#10-24 FLAT HEAD SCREWS	2
2	P55502	FOOTSWITCH COVER	1
3	P55501	FOOTSWITCH HOUSING	1
4	P55503	SWITCH/NUT ASSEMBLY	2
5	P55505	#10 -24 LOCK NUT	2
6	P55507	PLASTIC NUT	2
7	P55506	SWITCH	2
Not Shown	P55510	30' BLACK 16 GA WIRE	1
Not Shown	P55511	30' RED 16 GA WIRE	1
Not Shown	P55512	30' WHITE 16 GA WIRE	1

**Limited Warranty**

- A. This Limited Warranty is given by the Powerwinch Division of the Scott Fetzer Company (the "Company") to the original purchaser (the "Purchaser") of a Powerwinch Product (the "Product") specified in this manual. This Limited Warranty is not transferable to any other party.
- B. Responsibilities of the Company under this Limited Warranty:
  - 1. Repair or replace (at the discretion of the Company) any part or parts of the Product found by the Company to be defective within a one (1) year period from the date of purchase.
  - 2. The Company will pay the transportation charge for shipment back to the Purchaser of any Product received for legitimate Warranty repair.
- C. Responsibilities of the Purchaser under this Limited Warranty:
  - 1. Purchaser will have to show dated proof of purchase to qualify for service under the provisions of the Limited Warranty.
  - 2. Promptly notify the Seller or the Company of any claim hereunder.
  - 3. At the Option of the Company, return the Product to the Company for inspection. Authorization must be given prior to any Product return. Call the Company at 1-513-539-7215 or write the Company at 301 Lawton Avenue, Monroe, OH 45050, for authorization and complete instructions on how to return the Product directly to the Company.
  - 4. Use reasonable care in maintenance, operation, use and storage of the Product in accordance with the instructions contained in the Owner's Manual.
  - 5. Have Warranty work performed by a dealer or representative approved by the Company.
  - 6. Except as noted in B.2., transportation charges are the responsibility of the Purchaser.
- D. This Limited Warranty covers:
  - 1. Defects in workmanship or materials.
  - 2. Any part or parts of the Product sold or manufactured by the Company.
- E. This Limited Warranty does not cover:
  - 1. Any failure that results from improper installation of the Product.
  - 2. Any failure that results from accident, Purchaser's abuse, neglect, modification, improper maintenance, or failure to operate and use the Product in accordance with the instructions provided in the Owner's Manual supplied with the Product.
- F. There is no other express warranty. Implied warranties, including those of merchantability and fitness for a particular purpose, are limited to one (1) year from date of purchase. This is the exclusive remedy and any liability for any and all incidental or consequential damages or expenses whatsoever is excluded.

Some states do not allow limitations on how long an implied warranty lasts, or do not allow exclusion or limitation of incidental or consequential damages, the above limitations may not apply to you. This Limited Warranty gives you specific legal rights, and you may also have other rights which vary from state to state.